

Instructions

Assembly
Installation
Operation

4/2009

Wellspring® Litter Surface Mounting Instructions

Hardware included for surfacing mounting:

- (4) Stainless Surface Mount Tabs
- (4) #12 Stainless Flat Head Screws

Tools required for attaching surface mount tabs:

- #2 Phillips Screwdriver
- Hand drill with a 11/64 (4.5mm) diameter drill bit

Each surface mount litter is shipped with four mounting brackets and screws to attach them to the litter legs. Each bracket has a 3/8" (9.5 mm) diameter hole for a 5/16 (8.0) diameter anchor.

1. Locate the hardware bag shipped with each bench.
2. Carefully place litter upside down on a smooth non-abrasive surface, remove the nylon glides from the bottom of the 4 litter legs.
3. Using the glide nail hole as a guide, drill an 11/64" (4.5 mm) diameter pilot hole for the flat head screws 1" (25 mm) deep in each leg.
4. Attach brackets facing inward with screws.

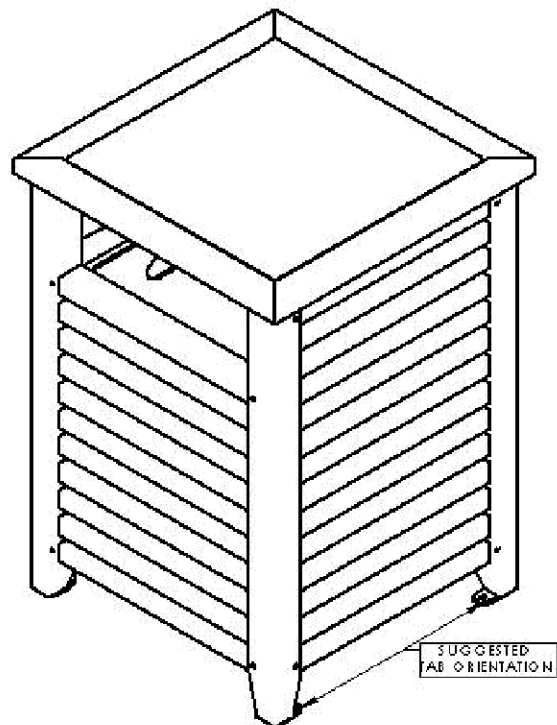
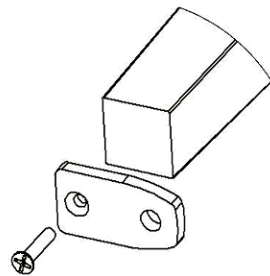

landscapeforms®

Page 1 of 2

431 Lawndale Avenue, Kalamazoo, MI 49048
PH: 800.521.2546, PH: 269.381.0396, FX: 269.381.3455

Instructions

Assembly
Installation
Operation

Recommended procedure for surface mounting:

WARNING! TO AVOID INJURY TO PERSONS HANDLING LITTERS, USE TWO PERSONS TO TEAM LIFT AND CARRY.

Although the anchoring procedure and hardware are the responsibility of the installer, we suggest the following:

1. Select corrosion resistant anchors appropriate for the surface. Your hardware store or builders supply may be able to recommend the proper hardware, tools, and safety equipment.
2. Place the litter in the desired position.
3. Mark the hole locations for anchors.
4. Move the litter to allow access for drilling holes.

Install the anchors and litter according to the anchor manufacturer's instructions.