

to protect your product,  
read operating instructions before opening parasol

# TUUCI®

*made in miami*



bay master MAX center post  
assembly & operating instructions

**Step 1**

Remove all packaging from umbrella, including inside the umbrella.

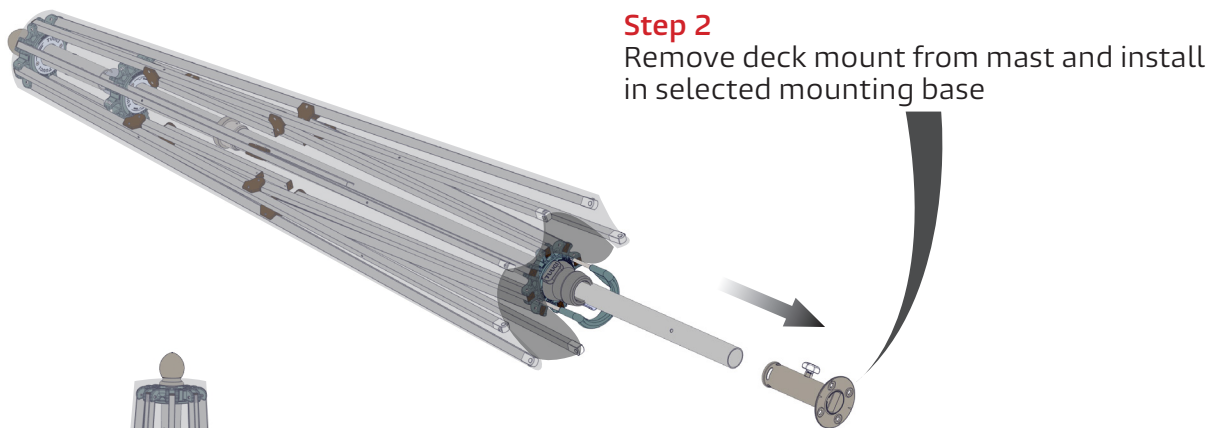
**Step 3**

Once deck mount is installed, place the umbrella inside the deck mount and tighten star-knob.

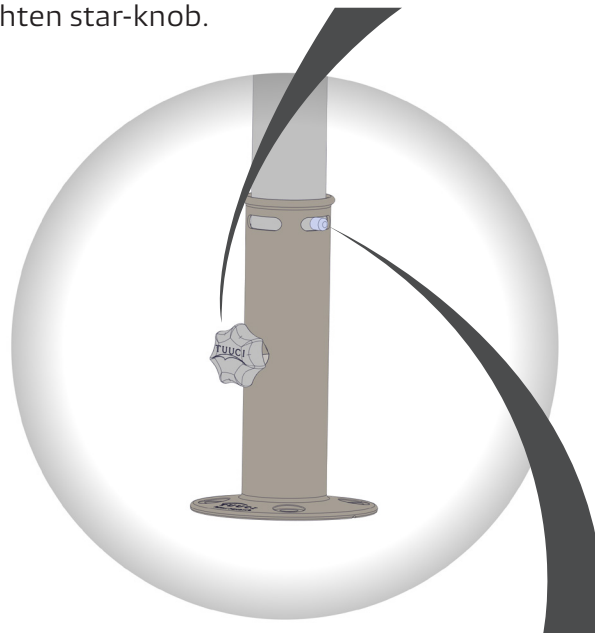
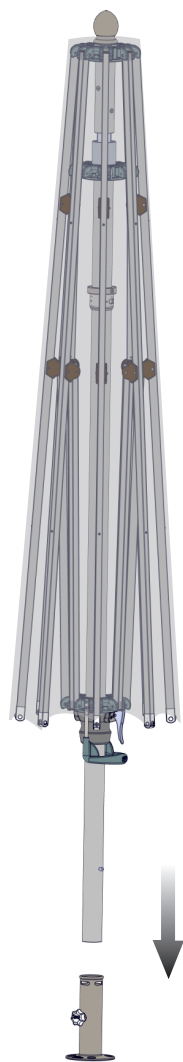

**Ensure lock spring pin is in base slot to secure umbrella in place**

applies to:



*square*



*octagon*

## POSITIONING UMBRELLA FRAME

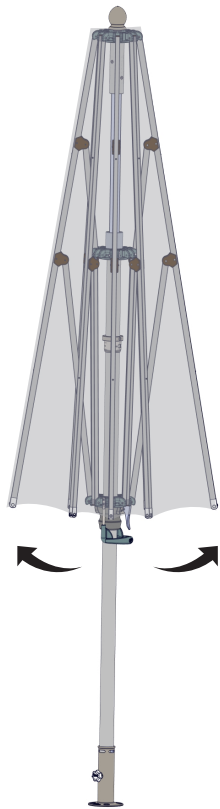
**Step 4**

Gently separate each rib individually from center post, approximately 10 inches

**Step 5**

Gently slide main hub handle up center post until clip bracket engages to slot

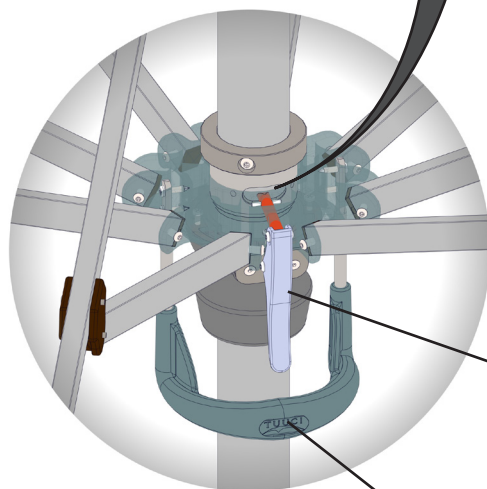

clip bracket

main hub handle

**Step 6**

Connect rib struts to hub with key ring clip.

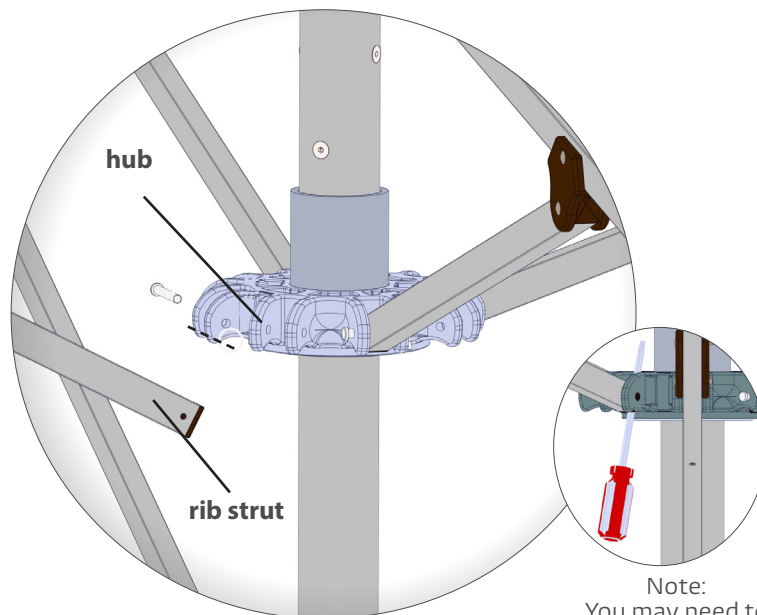

Note:  
You may need to  
use a tool to help  
align the holes.

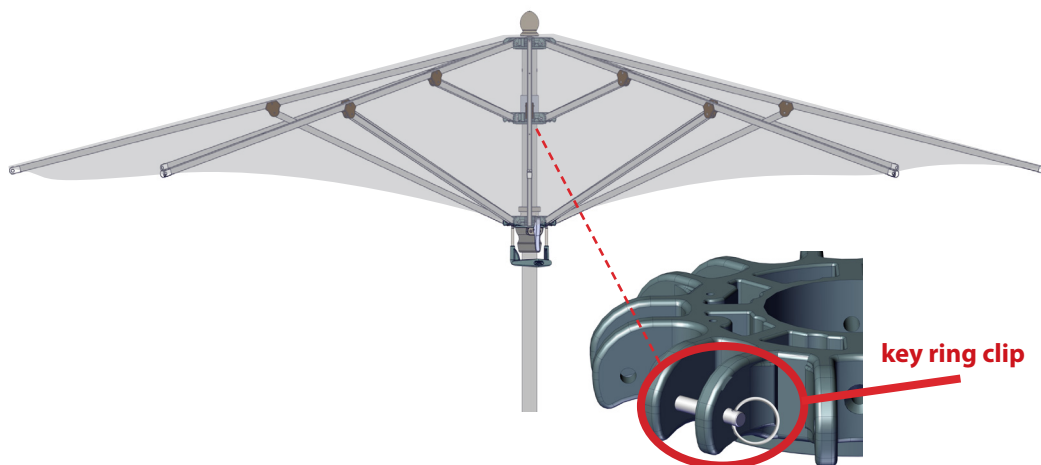

**DO NOT OPERATE  
WITHOUT CONNECTING  
RIB STRUTS TO HUB  
WITH KEY RING CLIP**

**Step 7**

To close umbrella, press down clip bracket to disengage from slot then slide down gently.

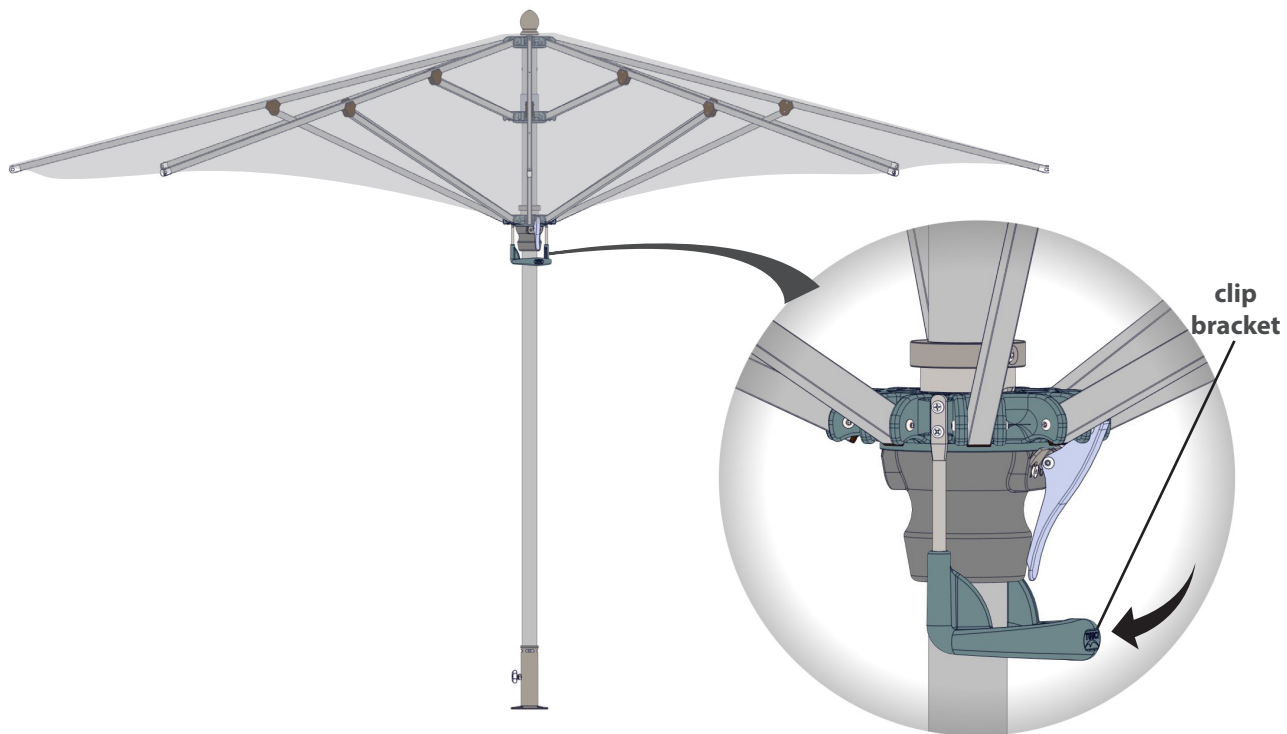

**Note:** close umbrella during wind conditions that exceed manufacturer's specifications.

## IF APPLICABLE - LIGHT ACCESSORIES

### Step 7

Connect electrical extension cable

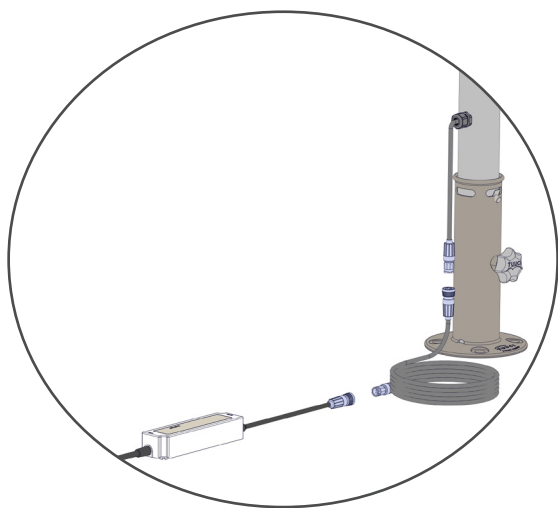

### Step 8

Per job application connect required a/c plug to the free ends of power supply



Image for illustration only  
a/c plug not included

### Step 9

Use touch sensor detector to control light brightness from low to high

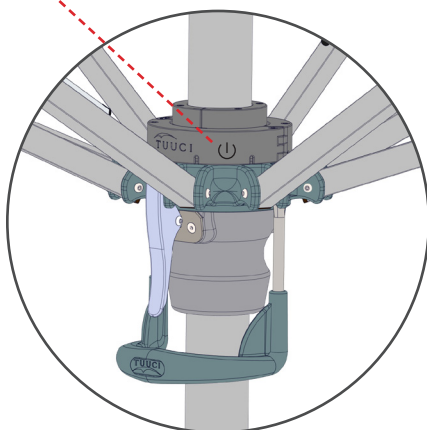

### LIGHTING SPECIFICATIONS

Power Supply:		
1.	Input Voltage	100-240 VAC/0.6 A 277 VAC/0.25 A
2.	Output Voltage	12 VDC
3.	Output Current	3.34 A
4.	Output Power	40 W

Light Specifications:		
1.	4 LED Bars with three (3) levels of brightness operated through a touch switch.	
2.	Operating Current:	
	A. Low:	0.07 A
	B. Medium:	0.25 A
	C. High:	0.60 A
3.	LED color temperature: 3000 K	

TUUCI frames are constructed from durable, marine-grade, weather resistant materials including: fiberglass, armor-wall aluminum, Dura-TEAK composites, Aluma-TEAK aluminum and sustainable hardwood. All fasteners (nuts, bolts, pulleys, cam cleats, etc.) are marine-grade stainless steel and will withstand the most corrosive environments. Proper care and maintenance is important to extend the serviceable life of all TUUCI products. We recommend the following:

- Fresh water rinses once a week
- Weekly inspection of your TUUCI product is recommended. Loose screws should be tightened and any broken components replaced immediately to avoid further damage to your product.
- Prior to opening, ensure that the shade product is properly secured to an adequate shade anchor system.
- When opening a TUUCI parasol, separate each rib 10 inches from the center post, before raising the hub. Do not force hub if it does not rise easily.
- When closing the parasol, pull the fabric out from between the struts to avoid pinching or damaging the TUFF-SKIN canopy membrane.
- TUUCI recommends that all collapsible shade equipment be closed in wind conditions which exceed 25 MPH.
- Clean above ground parasol bases regularly to maintain appearance. To clean, gently wash with soap and water using a nonabrasive cloth or pad.
- Check bolts in security stem regularly to ensure that they remain fully tightened.
- Do not roll Aluma-crete (Aluminum Shell, Concrete Filled) bases on their side as damage to shell or finish can occur.
- Do not use on stairways or over distances which exceed 50 feet, as damage to welded wheel tray may occur.
- Canopy should be cleaned regularly and can be cleaned without being removed from the frame. Hose down and clean with a mild soap and lukewarm water (no more than 100° F) using a soft bristle brush. Rinse thoroughly to remove soap. Allow fabric to air dry. TUUCI Parts can be purchased at [parts@tuuci.com](mailto:parts@tuuci.com).
- Do not use a pressure washer to clean canopies.