



Umbrella, table mount



Umbrella, stand mount

## Included components

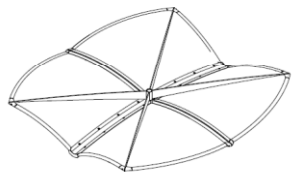

Canopy

Pole,  
table mount

or

Pole,  
stand mountTop cap with  
screw

## Tools Required

- 5/16" Hex key for assembling umbrella
- For installing umbrella to table or stand:
  - No. 2 Phillips screwdriver
  - 7/16" wrench or adjustable wrench
  - Proper personnel for lifting umbrella – weight is approximately 110 lbs.

**NOTE:** If specifying Shade umbrella with Landscape Forms' Charlie or Manistee picnic tables, the surface mount stand must also be specified. For all other Landscape Forms tables or picnic tables, the umbrella secures to the table and no stand is required. The hardware for securing the umbrella to the table or stand is shipped with the support.

See separate installation guides for surface mount stand or table.

**Storage:** It is recommended to leave the Shade unit installed all year.

**ASSEMBLE WITH CARE!** Pangard II® Polyester Powdercoat is a strong, long-lasting finish. To protect this finish during assembly, place unwrapped powdercoated parts on packaging foam or other non-marring surface. Do not place or slide powdercoated parts on concrete or other hard or textured surface – this will damage the finish causing rust to occur. Use touch-up paint on any gouges in the finish caused by assembly tools.

**WARNING: SHADE UMBRELLA MUST BE USED WITH SURFACE MOUNTED OR EMBEDDED TABLE OR SURFACE MOUNT STAND.**

## PROCEDURE FOR INSTALLATION:

1. Install and anchor table or surface mount stand according to installation guides.
2. Insert the pole into the canopy assembly, aligning the notch on the pole collar to fit onto the bottom gusset. See Fig. 1.
3. Install the top cap with the 3/8-16 x 2" socket button head cap screw. Tighten to 15 ft/lbs. See Fig. 2.
4. Lift assembled umbrella into hole in table or surface mount stand, taking care not to scratch the tabletop.
5. Turn umbrella to align holes in support and pole. Insert 1/4-20 bolt through holes and install locknut. This hardware is shipped with the table support or surface mount stand. The surface mount stand has two screws and locknuts. See Fig. 3.

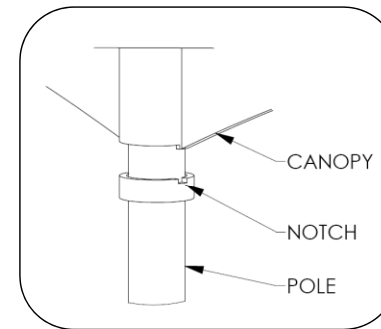

Fig. 1 – Install pole

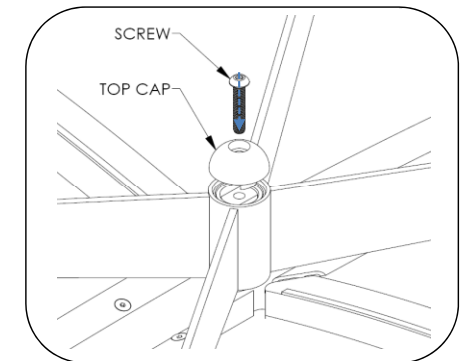

Fig. 2 – Install top cap

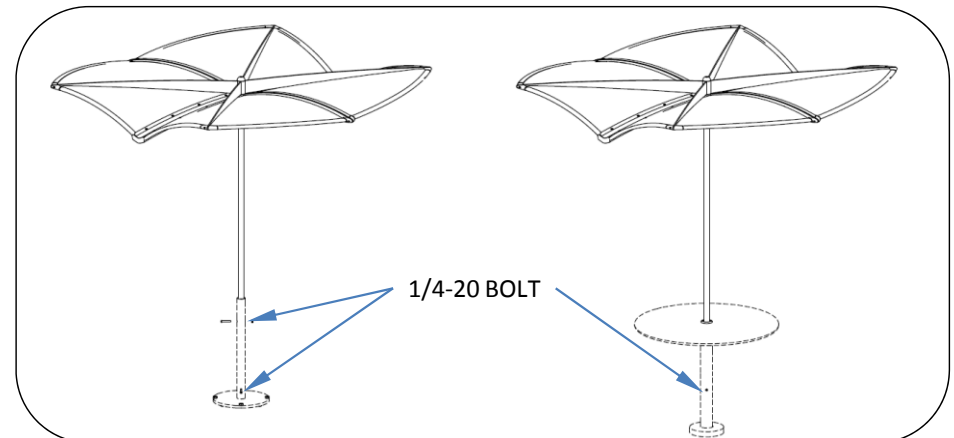

Fig. 3 – Secure umbrella