

## Included components

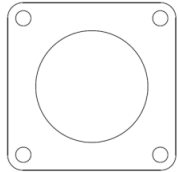

1x – wooden drill template

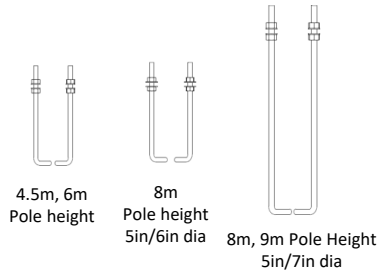

Included: hardware is galvanized

**4.5m and 6m pole:** (4) anchor bolts, 3/4"-10 x 17" x 3" hook ,  
(8) heavy hex nuts, 3/4" x 10, (8) flat washers, .81 ID" x 1.5" OD x 0.13" thick  
**8m (5in/6in) pole:** (4) anchor bolts, 3/4"-10 x 17" x 3" hook ,  
(8) heavy hex nuts, 3/4" x 10, (8) flat washers, .81 ID" x 2" OD x 0.13" thick  
**8m and 9m (5in/7in) pole:** (4) anchor bolts, 1"-8 x 36" x 4" hook,  
(8) heavy hex nuts, 1" x 8, (8) flat washers, 1.06" ID x 2.00" OD x 0.15" thick

## Tools Required

- Safety glasses
- Wrenches, 1-1/4" for 4.5m, 6m or 8m (5in/6in) pole
- Wrenches, 1-5/8" for 8m or 9m (5in/7in) pole
- Level

## LIGHTING LAYOUT RECOMMENDATIONS:

Refer to the product data sheet available at [www.landscapeforms.com](http://www.landscapeforms.com) for recommendations for light pole spacing.

**Landscape Forms is not responsible for site preparation and footings. The following chart gives necessary information for calculating proper footing size, depending on the specified light pole.**

**WARNING!** Pole mounted luminaires must be attached either before or *immediately* after pole installation. Failure to do so may cause vibration damage to the pole and will void the pole warranty.

Pole Size	Base Overturning Moment (ft-lbf)	Base Shear (lbf)
5" x .125" x 4.5m	4037	353
5" x .188" x 6m	5874	400
6" / 5" x .188" x 8m	8633	455
7" / 5" x .188" x 8m	11,826	566
7" / 5" x .188" x 9m	10,636	494

\*Calculations per AASHTO 1994, assuming base of the pole is at grade level, with 90mph fastest mile wind speed with 1.3 gust max.

## INSTALLATION PROCEDURE FOR ANCHOR BOLTS:

1. Prepare footing as required by local codes.
2. Install anchor hooks, hex nuts, washers and wooden template as shown in Fig 3 and Fig. 4. Level template in all directions. **Note:** template thickness is less than base plate thickness. Dimensions given account for the difference.
3. After footing has properly cured, remove wooden template. Do not remove lower hex nuts or washers.

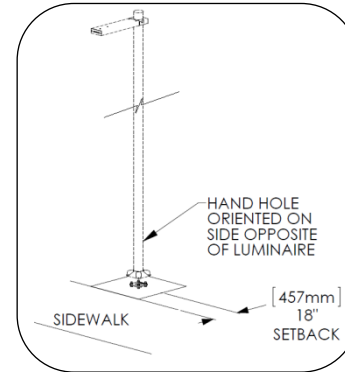

Fig. 1 – Sidewalk setback

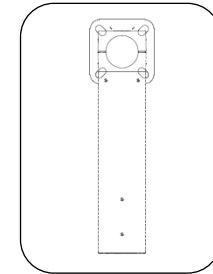

Fig. 2 – Base plate orientation to luminaire

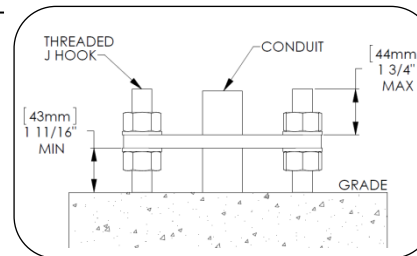

Fig. 3 – Anchor install detail, 5in or 6in pole

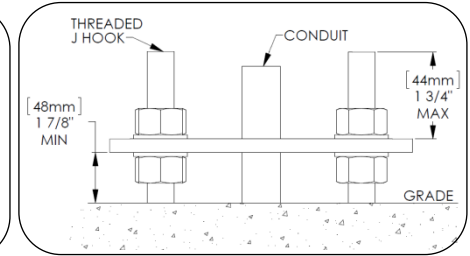
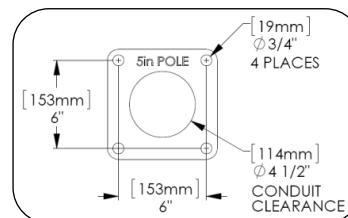
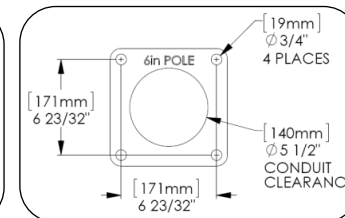

Fig.4- Anchor install detail, 7in pole



5" diameter pole



6" diameter base pole

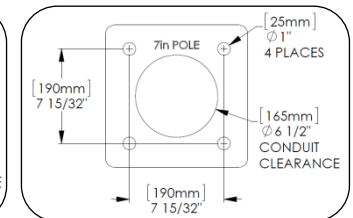

7" diameter base pole

## Included components

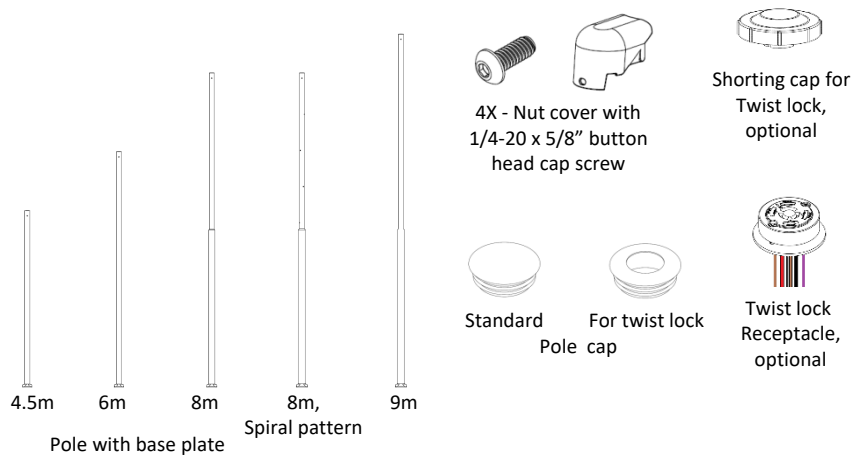

## Tools Required

- Safety glasses
- Wrenches, 1-1/4" for 4.5m, 6m or 8m (5in/6in) pole or 1-5/8" for 8m (5in/7in) or 9m pole
- Wiring tools and connectors
- Proper personnel, crane or lift for hoisting unit onto anchors
- Level
- Dimming control, if required
- Hex keys, 8mm for luminaire, 5/32" for nut covers
- Twist lock photo eye, if required

## Landscape Forms is not responsible for site preparation and footings.

**CAUTION!** This unit is heavy. To avoid injury or damage to the finish, we recommend using a crane or lift for hoisting the unit onto the anchors.

**WARNING!** Pole mounted luminaires must be attached either before or *immediately* after pole installation. Failure to do so may cause vibration damage to the pole and will void the pole warranty.

**ASSEMBLE WITH CARE!** To protect this finish during assembly, place unwrapped powdercoated parts on packaging foam or other non-marring surface. Do not place or slide powdercoated parts on concrete or other hard or textured surface – this will damage the finish causing rust to occur. Use touch-up paint on any gouges in the finish caused by assembly tools.

## INSTALLATION PROCEDURE FOR LIGHT POLE:

1. Lift the light pole into position over the installed anchors (refer to Rama anchor kit installation guide) as shown in Fig. 5. Ensure that the base plate is resting on all four washers.
2. Install washer and hex nut as shown in Fig. 5.
3. Plumb and level the pole and tighten all anchors.
4. Install luminaire. Refer to separate luminaire installation guide for mounting luminaire to pole.
5. Install the top cap on the pole (shipped with the pole). If the unit has a twist lock receptacle, assemble the receptacle and the top cap as shown in Fig. 7 and connect wiring before installing the top cap. Install provided shorting cap or photo-electric control.
6. Install the nut covers as shown in Fig. 6.

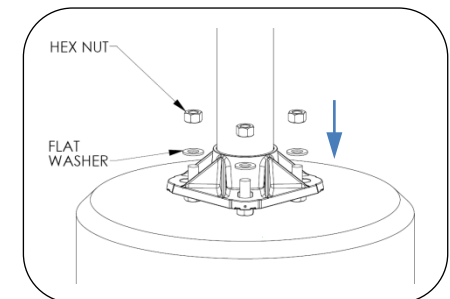

Fig. 5 – Install pole

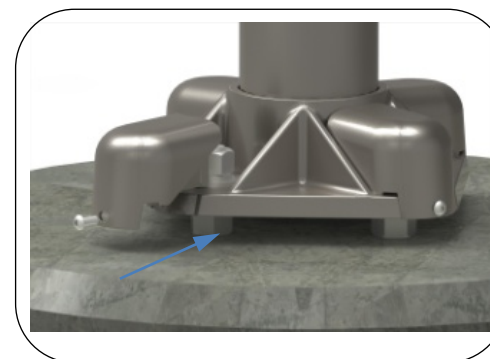

Fig. 6 – Install nut covers

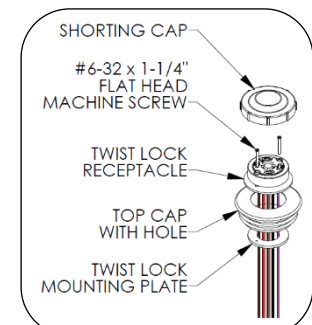

Fig. 7 – Install optional twist lock receptacle to top cap