

Included components

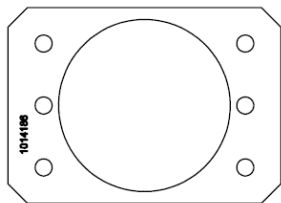

Template

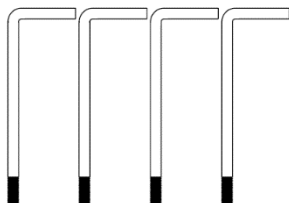

4X – 3/8-16 L-bolt



8X – 3/8-16
Hex Nuts



8X – 3/8-16
Flat Washers

ASSEMBLE WITH CARE! To protect this finish during assembly, place unwrapped powdercoated parts on packaging foam or other non-marring surface. Do not place or slide powdercoated parts on concrete or other hard or textured surface – this will damage the finish causing rust to occur. Use touch-up paint on any gouges in the finish caused by assembly tools.

Landscape Forms is not responsible for site preparation and footings.

IMPORTANT! Please read all instructions before beginning installation.

Legrand Electrical systems conform to and should be properly grounded in compliance with requirements of the current National Electrical Code or codes administered by local authorities.

All electrical products may present a possible shock or fire hazard if improperly installed or used. Legrand electrical products may bear the mark of a nationally Recognized Testing Laboratory and should be installed in conformance with current local and/or the National Electrical Code.

Tools Required

- Safety glasses
- Wrenches, 1/2", 9/16"
- Level

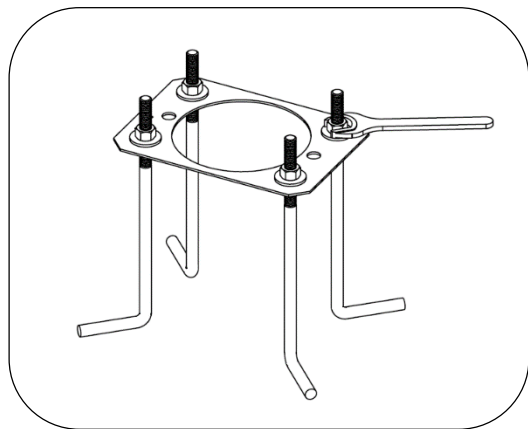

Step 1 – Secure L bolts to template

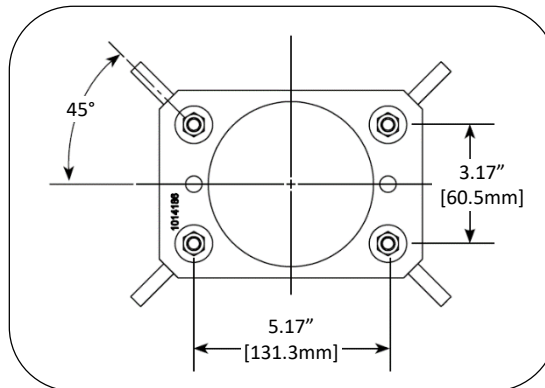

Step 1a – L bolt orientation on template

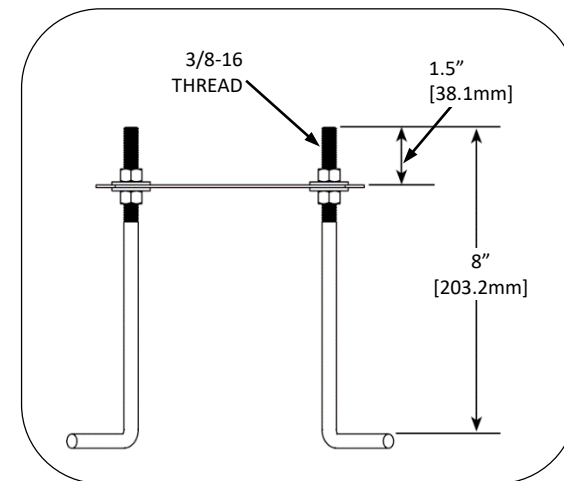

Step 1b – L bolt placement with nuts and washers

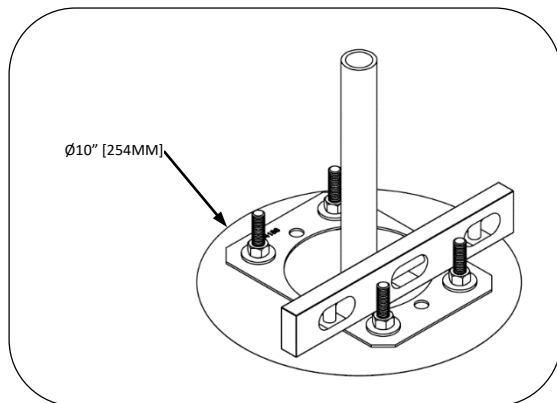

Step 2 – Sink and level template in concrete up to nuts on bottom side of template. Conduit needs to extend out of concrete at least 8" (203mm).

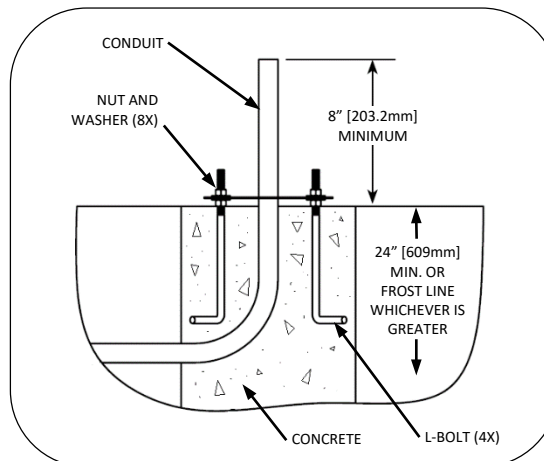

Step 2a – Side elevation of installed template with bolts, nuts and washers.