

right

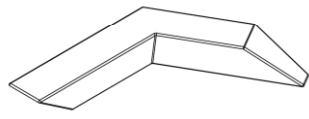

left

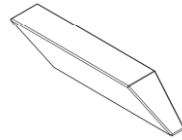

straight

**INSTALLATION:**

1. Determine placement of bench.
2. Set in place with proper equipment such as a crane. See Fig. 1.

Included components: No assembly required

**Tools required:**

- Crane or proper equipment to move 1499 lbs. (straight unit) or 2242 lbs. (right or left units)
- Wood supports or straps

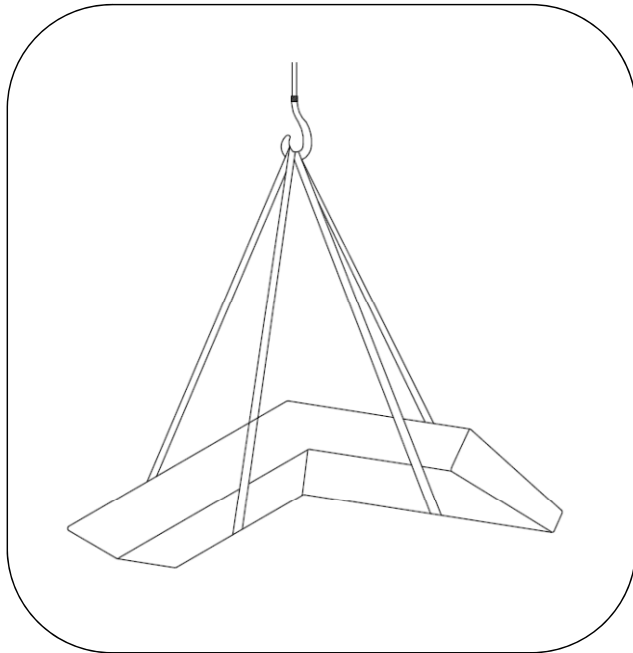

Fig. 1 – Crane install – strap locations

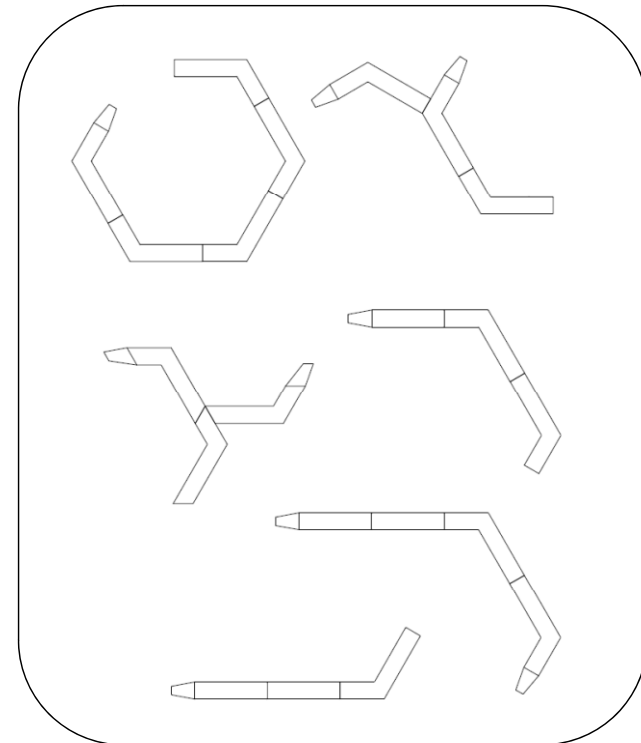

Fig. 2 – Optional configurations