

AS208-01
SHELF

Included components:

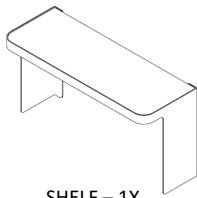

SHELF – 1X

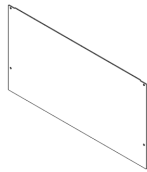

SHELF BACK
PANEL – 1X

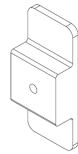

CLAMP – 4x

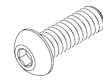

1/4-20 x 3/4"
SBHCS
– 4x



5/8" O.D.
WASHER
– 4x

INSTALLATION: Shelf only mounts to horizontal slat wall panel.

1. Place shelf back panel inside shelf with corner notches oriented toward the top of the panel.
2. Align shelf, back panel, screw and washer from the front side of the wall panel and place a clamp on the back side of the panel. Drive screw into clamp to secure. Repeat for all four clamps. See Fig. 1.

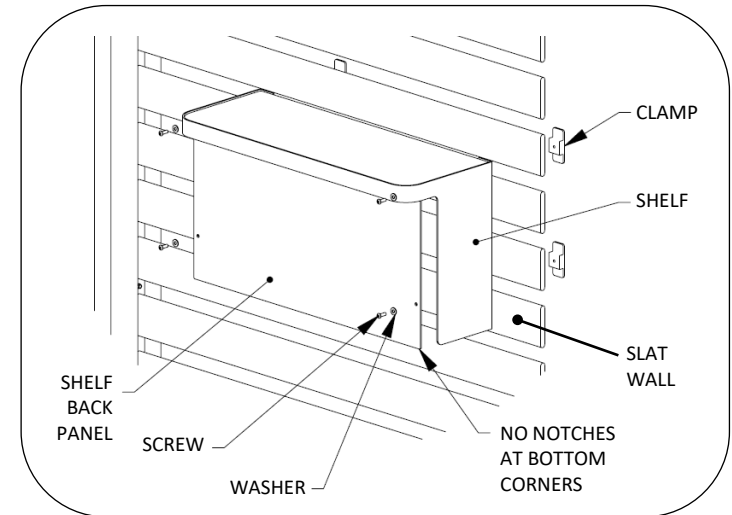

Fig. 1– INSTALL SHELF

ASSEMBLE WITH CARE! Pangard II® Polyester Powdercoat is a strong, long-lasting finish. To protect this finish during assembly, place unwrapped powdercoated parts on packaging foam or other non-marring surface. Do not place or slide powdercoated parts on concrete or other hard or textured surface – this will damage the finish causing rust to occur. Use touch-up paint on any gouges in the finish caused by assembly tools.