

### Included components

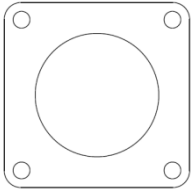

1x – wooden drill template

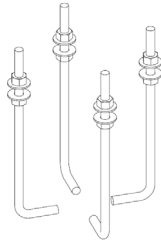

Anchor kit

Included: hardware is galvanized

(4) anchor bolts, 3/4"-10 x 17" x 3" hook ,  
(8) heavy hex nuts, 3/4" x 10, (8) flat washers, .81 ID" x 1.5" OD x 0.13" thick

### Tools Required

- Safety glasses
- Wrenches, 1-1/4"
- Level

### LIGHTING LAYOUT RECOMMENDATIONS:

Refer to the product data sheet available at [www.landscapeforms.com](http://www.landscapeforms.com) for recommendations for light pole spacing.

**Landscape Forms is not responsible for site preparation and footings. Refer to pole drawings for pole calculations required for footing design.**

**WARNING!** Pole mounted luminaires must be attached either before or *immediately* after pole installation. Failure to do so may cause vibration damage to the pole and will void the pole warranty.

**ASSEMBLE WITH CARE!** Pangard II® Polyester Powdercoat is a strong, long-lasting finish. To protect this finish during assembly, place unwrapped powdercoated parts on packaging foam or other non-marring surface. Do not place or slide powdercoated parts on concrete or other hard or textured surface – this will damage the finish causing rust to occur. Use touch-up paint on any gouges in the finish caused by assembly tools.

### INSTALLATION PROCEDURE FOR ANCHOR BOLTS:

1. Prepare footing as required by local codes.
2. Install anchor hooks, hex nuts, washers and wooden template as shown in Fig 1. Level template in all directions. **Note:** template thickness is less than base plate thickness. Dimensions given account for the difference.
3. After footing has properly cured, remove wooden template. Do not remove lower hex nuts or washers.

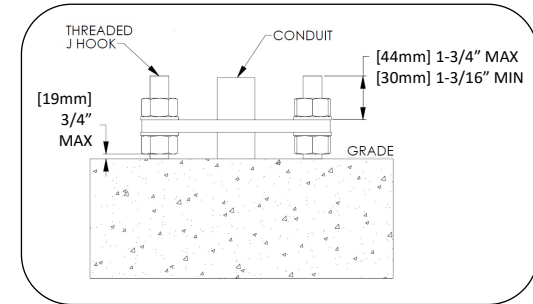
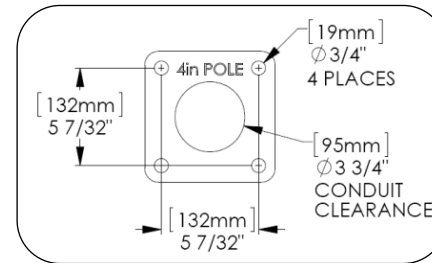
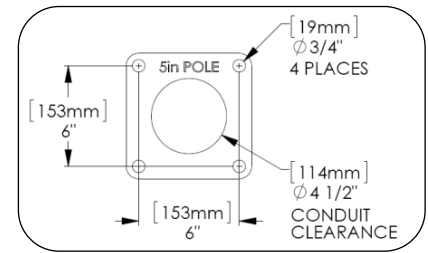

Fig. 1 – Anchor install detail



4" diameter pole



5" diameter pole