

Included components

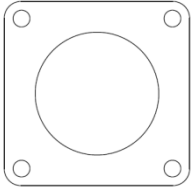

1x – wooden drill template

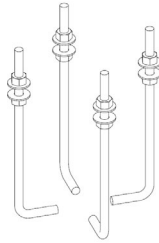

Anchor kit

Included: hardware is galvanized

For 5in straight poles (12ft/14ft/16ft/20ft):

- (4) anchor bolts, 3/4"-10 x 17" x 3" hook ,
- (8) heavy hex nuts, 3/4" x 10, (8) flat washers, .81 ID" x 1.5" OD x 0.13" thick

For 5in/6in stepped poles (25ft):

- (4) anchor bolts, 3/4"-10 x 17" x 3" hook ,
- (8) heavy hex nuts, 3/4" x 10, (8) flat washers, .81 ID" x 2" OD x 0.13" thick

Tools Required for anchor installation:

- Safety glasses
- Wrenches, 1-1/4"
- Level

LIGHTING LAYOUT RECOMMENDATIONS:

Refer to the product data sheet available at www.landscapeforms.com for recommendations for light pole spacing.

Landscape Forms is not responsible for site preparation and footings. Refer to pole drawings for pole calculations required for footing design.

WARNING! Pole mounted luminaires must be attached either before or *immediately* after pole installation. Failure to do so may cause vibration damage to the pole and will void the pole warranty.

ASSEMBLE WITH CARE! Pangard II® Polyester Powdercoat is a strong, long-lasting finish. To protect this finish during assembly, place unwrapped powdercoated parts on packaging foam or other non-marring surface. Do not place or slide powdercoated parts on concrete or other hard or textured surface – this will damage the finish causing rust to occur. Use touch-up paint on any gouges in the finish caused by assembly tools.

INSTALLATION PROCEDURE FOR ANCHOR BOLTS:

1. Prepare footing as required by local codes.
2. Install anchor hooks, hex nuts, washers and wooden template as shown in Fig 1. Level template in all directions.
3. After footing has properly cured, remove wooden template. Do not remove lower hex nuts or washers.

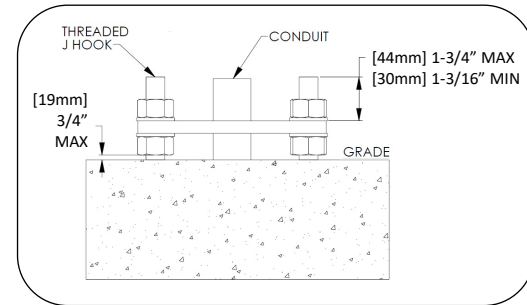
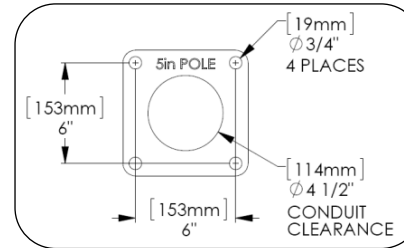
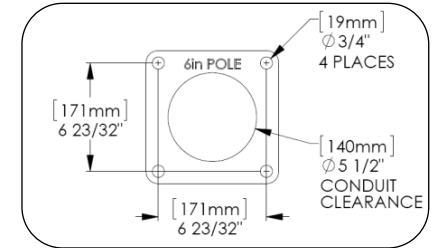

FIG. 1 – ANCHOR INSTALL DETAIL



5" diameter pole



6" diameter pole

Included components: Light poles included, refer to site plans for heights and luminaire styles.



Area light



Accent light



Accent light
with louvre

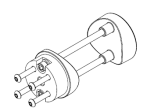

Clamp for single
luminaire



Motion
sensor
(optional)

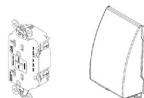

GFCI outlet and
cover (optional)

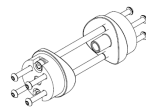

Clamp for
back to back
luminaires



Twist lock
receptacle
(optional)



Shorting cap for
Optional Twist
lock

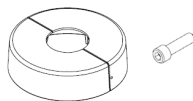

Cover plate
assembly (optional)

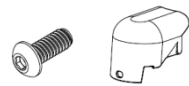

Nut cover with 1/4-20
x 1/2" button head
cap screw

Tools Required for installation:

- Safety glasses
- Wrenches, 1-1/4" (anchors), 30mm (adjusting rotation of luminaire)
- Level
- Phillips and flat head screwdrivers
- Hex keys/drivers:
 - 4mm for arm cover plate
 - 5mm for arm to clamp attachment
 - 6mm for adjusting tilt rotation on Accent luminaire
 - 8mm for clamp install
 - 5/32" for nut cover install
 - 3/16" for base cover install
- Wiring tools and connectors
- Twist-lock photo eye control, if required
- Dimming control, if required
- Proper personnel, crane or lift for hoisting unit onto anchors

WARNING! Installer must provide strain relief to line-in wires where they connect to light fixture wires. Failure to do so may cause electrical failure and will void warranty.

WARNING!: LED cartridge and driver are not rated for connection or disconnection while energized. Doing so may damage LEDs and will void the warranty. Disconnect incoming power before making or breaking any electrical connections.

INSTALLATION PROCEDURE FOR LIGHT POLE:

Note: assembled unit is heavy. Wiring connections should be made before lifting pole onto anchors. Wiring connections are made inside the luminaire arm. The luminaire hood should not be opened during installation.

RUN WIRING:

1. Using protective padding, position base plate of pole near conduit location. Ground line in must be connected to ground lug near handhole. Ground wire extends up the pole for all configurations.

For poles with GFCI outlet:

1. Run line-in voltage wiring inside pole base plate, extending out through the receptacle hole for the GFCI outlet. Connect line-in voltage wiring to line terminals on outlet receptacle. Attach receptacle and housing to pole. Refer to wiring diagram for GFCI outlet.

For poles with motion sensor:

1. Run line-in voltage wiring inside pole base plate, extending out through the motion sensor mount bracket, see Fig. 12.
2. Connect the line-in voltage wiring and dimming wiring to the motion sensor, refer to the wiring diagram for motion sensor.
3. Run wiring from motion sensor through the sensor mount bracket and out through the luminaire wiring access hole, see Fig. 7.
4. Thread the occupancy sensor onto the mount bracket until snug, with the sensor aligned with base of the pole, see Fig. 12.

For poles with twist-lock receptacle:

1. Run line-in voltage wiring inside pole base plate, extending out through the top of the pole.
2. Connect line-in voltage wiring to the twist-lock receptacle, see Fig. 13. Run line-in voltage wiring and dimming wires to luminaire wiring access hole, see Fig. 7. Refer to wiring diagram for units with twist-lock.
3. For units with twist-lock receptacle, replace supplied shorting cap with photo-control (supplied by others).

INSTALL LUMINAIRE/POLE ASSEMBLY

1. Attach clamp to pole. For single luminaires, note front clamp and back clamp orientation and location of holes on pole, see Figs. 2 and 3. For back to back luminaires, see Figs. 2 and 4.
2. Remove luminaire arm cover plate, see Fig. 5. Set hardware aside. Driver components are attached to cover plate, leave installed.
3. Attach luminaire arm to the clamp installed on the pole, see Fig. 6.
4. Run line-in voltage wiring, and dimming wires if applicable, through access hole and connect to wago block, see Fig. 7.
5. Make dimming/motion sensor wire connections inside luminaire arm.

INSTALLATION PROCEDURE (continued):

To adjust twist rotation: Note, luminaire ships installed with front of light distribution at 0deg. Leave Front sticker on luminaire hood until assembly is complete.

1. With arm cover plate removed, disconnect lanyard and wiring to wago block at the luminaire hood, see Fig. 8, to allow access for socket to fit over nut.
2. Loosen the nut enough to allow rotation of the luminaire hood. Do not remove nut. Indicators on arm, see Fig. 9, are shown in 15deg increments for reference. Rotate luminaire to desired location and tighten nut to 75 ft-lbs when in position.
3. Reconnect lanyard and wiring to wago block from luminaire.
4. Reinstall luminaire arm cover plate.

To adjust tilt rotation: (for accent lights only)

1. Loosen bolt, see Fig. 10, until gears are free to rotate. Do not remove bolt. Rotate as needed. Gears are set at 10deg increments. Once luminaire is in correct position, tighten bolt.

Set pole on anchors:

1. Lift the light pole into position over the installed anchors as shown in Fig. 14. Ensure that the base plate is resting on all four washers.
2. Install washers and hex nuts as shown in Fig. 14.
3. Plumb and level the pole and tighten all anchors.
4. See Fig. 15 for nut cover installation or Figs. 16 and 17 for base cover installation.

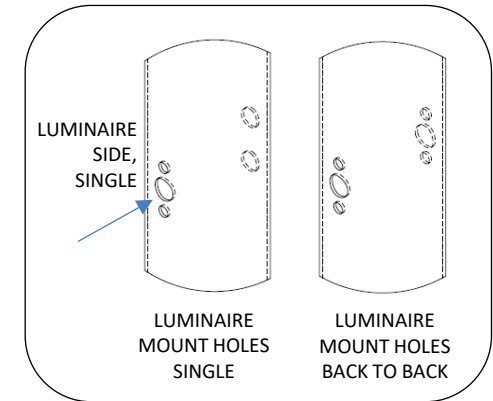

Fig. 2 – LUMINAIRE MOUNTING HOLES

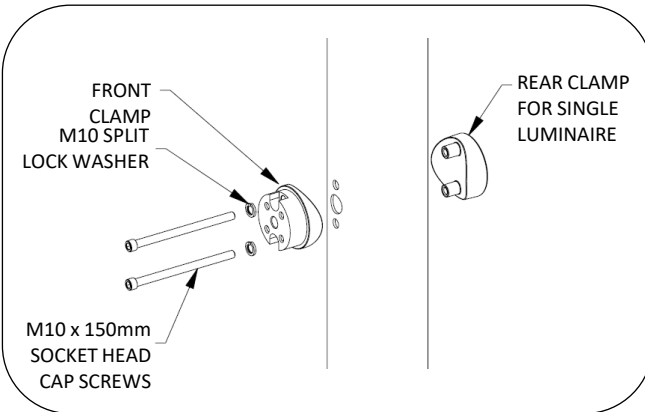

Fig. 3 – INSTALL SINGLE LUMINAIRE CLAMP

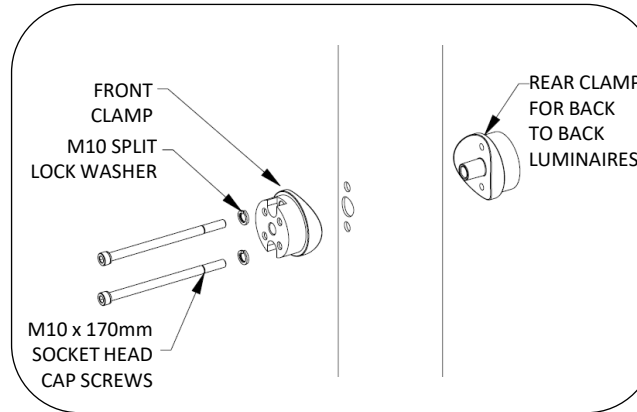

Fig. 4 – INSTALL BACK TO BACK LUMINAIRE CLAMP

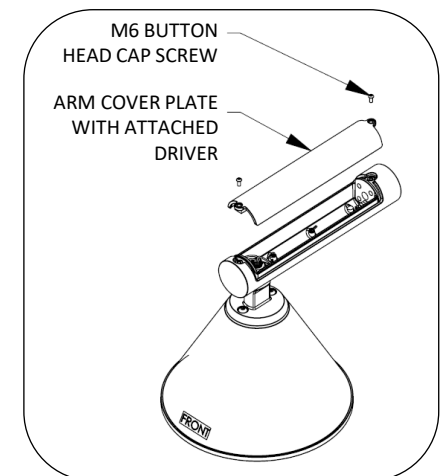

Fig. 5 – REMOVE ARM COVER PLATE

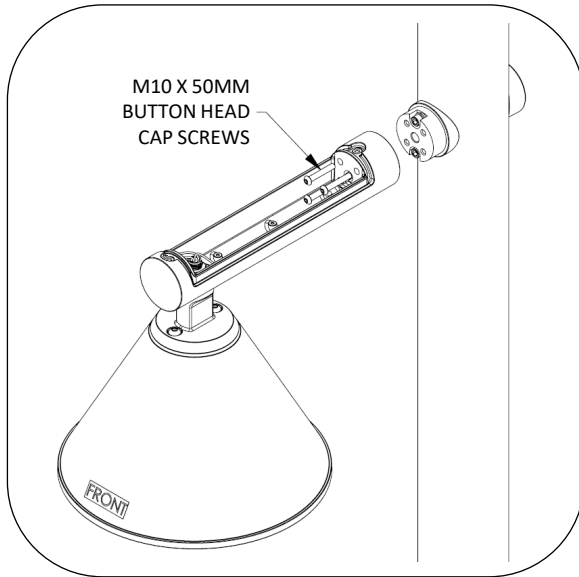

Fig. 6 – ATTACH ARM TO CLAMP

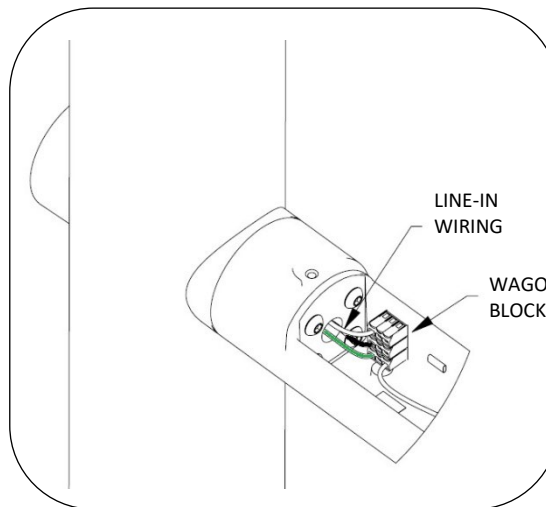

Fig. 7 – CONNECT LINE-IN WIRING

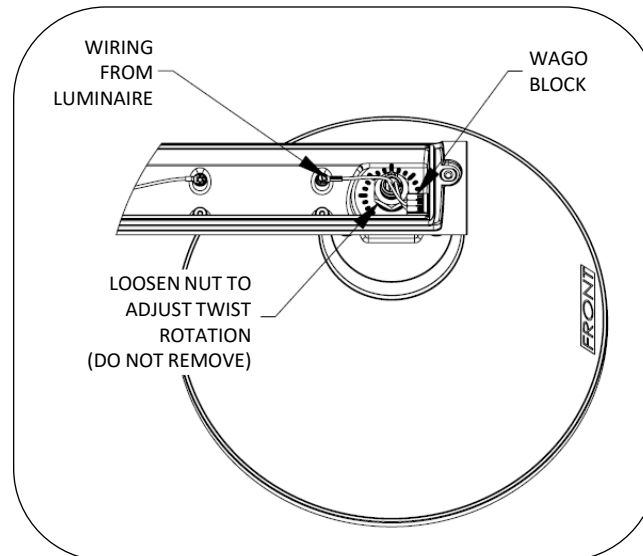

Fig. 8 – ADJUST TWIST ROTATION (AREA AND ACCENT LUMINAIRES)

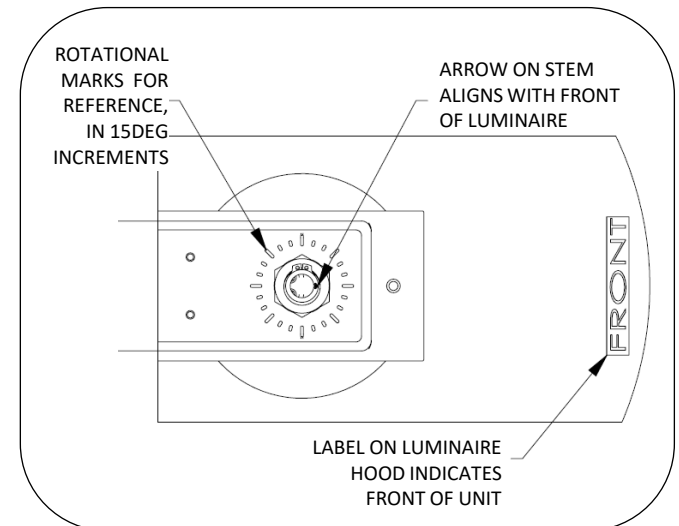

Fig. 9 – ADJUST TWIST ROTATION (AREA AND ACCENT LUMINAIRES)

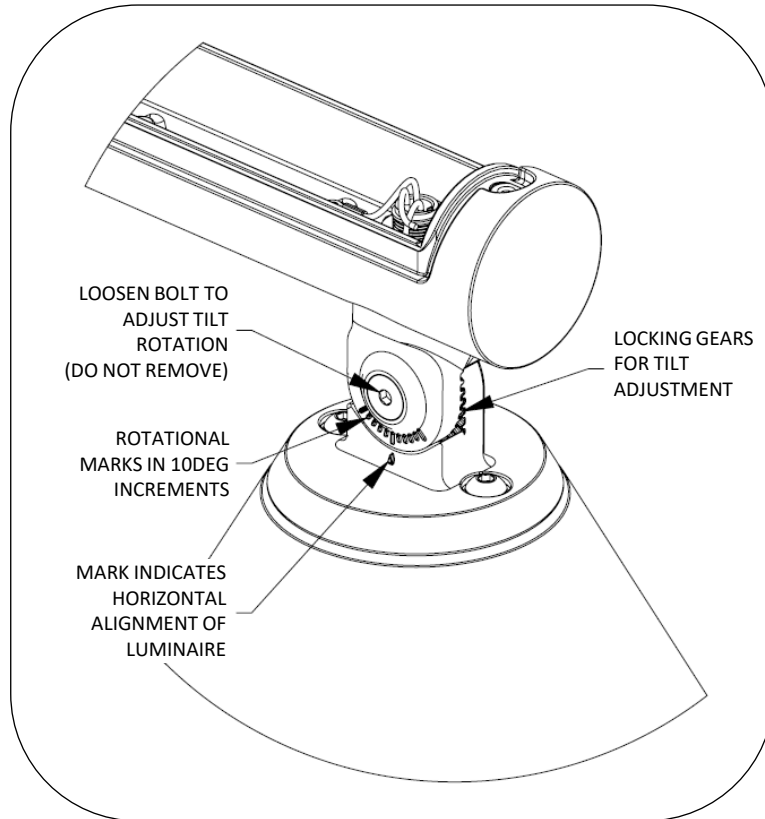

Fig. 10 – ADJUST TILT ROTATION (ACCENT LUMINAIRE ONLY)

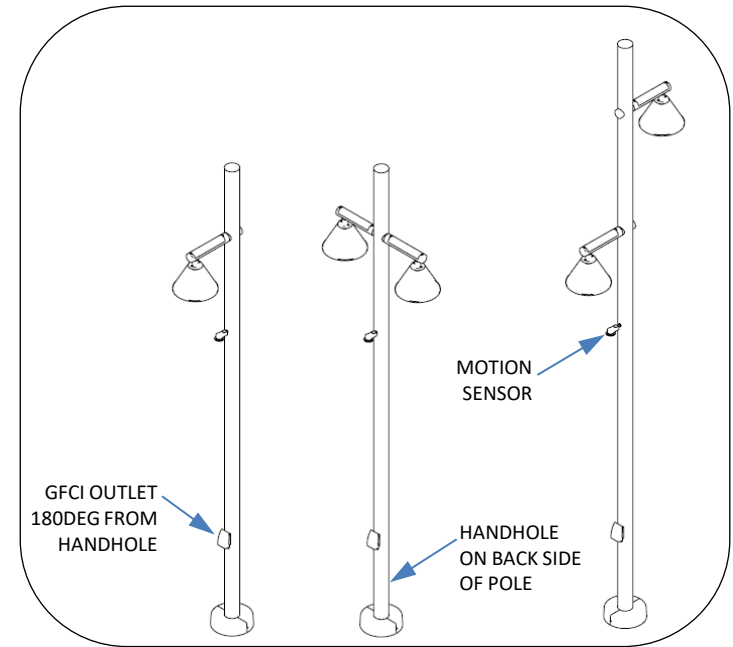

FIG. 11 – ACCESSORY LOCATIONS

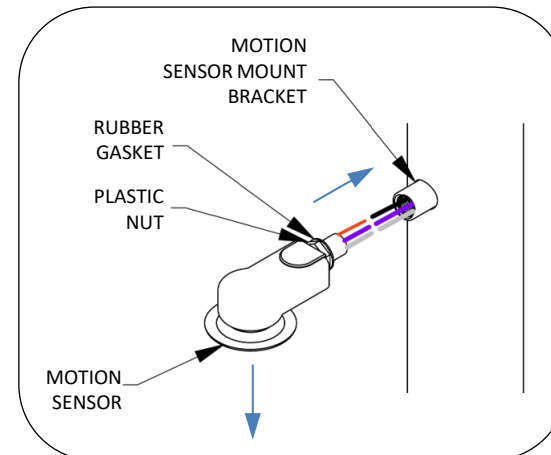

FIG.12– INSTALL OPTIONAL MOTION SENSOR

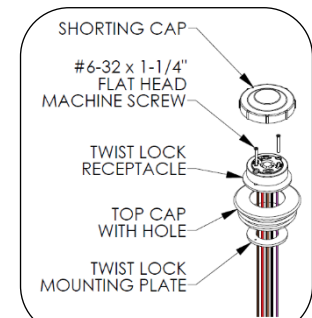

FIG. 13 – INSTALL OPTIONAL TWIST LOCK RECEPTACLE

PROCEDURE FOR WIRING MOMENT:

The luminaire is assembled at the factory. The light cartridge is mounted into the head of the luminaire and will not need to be removed during installation. The LED cartridge is wired to the driver (located in the arm bracket) at the factory. Use of LED drivers other than the supplied unit is not recommended and will void the warranty.

The wiring schematics are to be used to connect the unit to line voltage. It is the responsibility of the installer to make sure that all connections are made in accordance with the NEC and local building codes. Connection hardware not included.

Line-in wires should be connected to the wago connectors as shown. Optional dimming control is not included.

WARNING!: LED cartridge and driver are not rated for connection or disconnection while energized. Doing so may damage LEDs and will void the warranty. Disconnect incoming power before making or breaking any electrical connections.

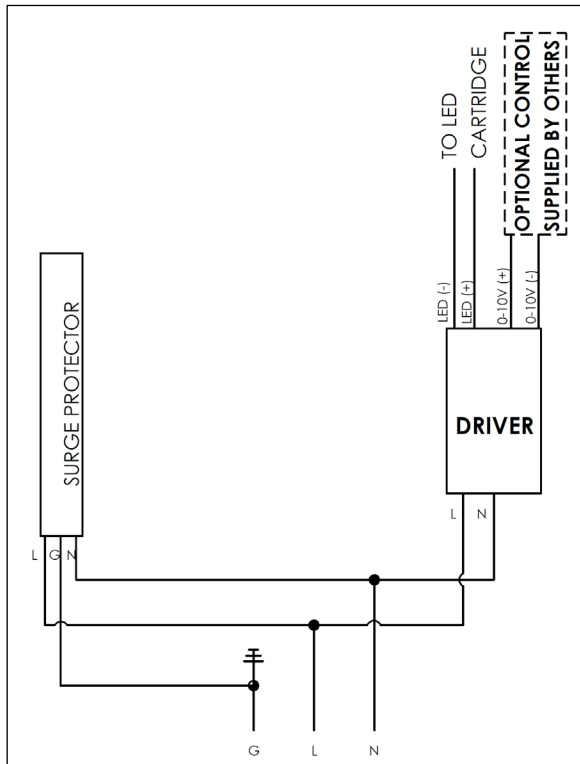

WIRING DIAGRAM: Moment luminaire (all styles)

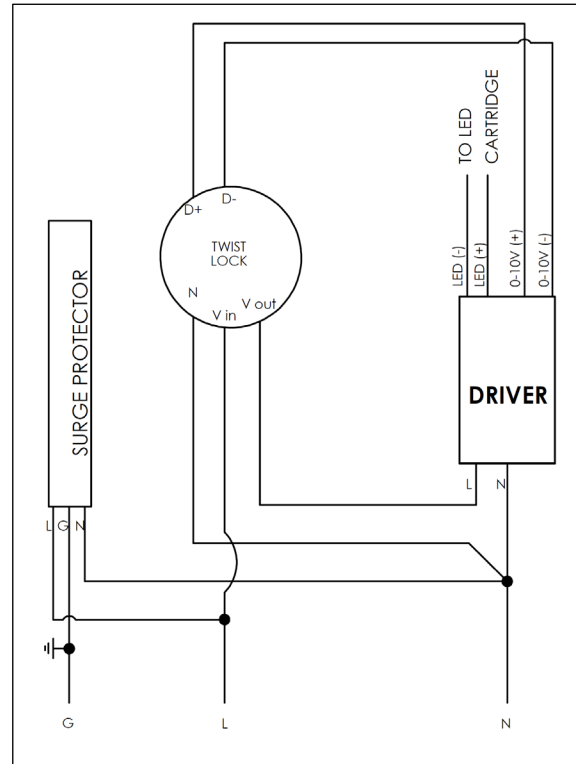

WIRING DIAGRAM: With twist lock

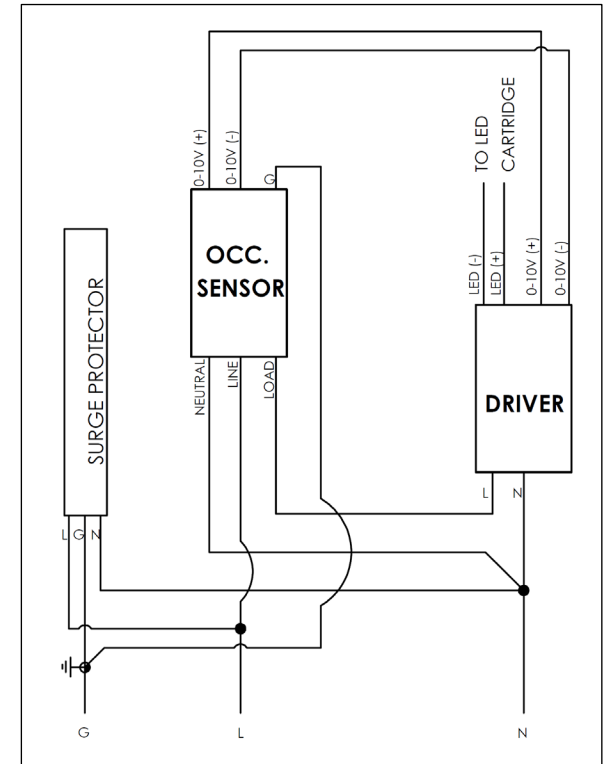

WIRING DIAGRAM: With motion sensor

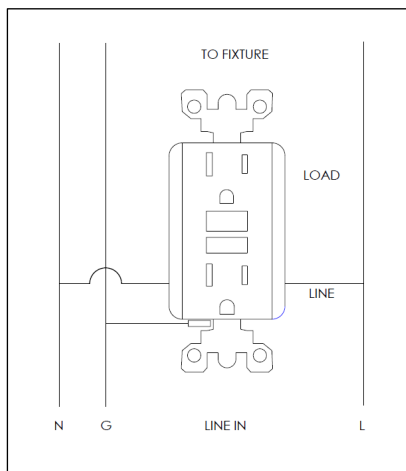

WIRING DIAGRAM: GFCI outlet

INSTALLATION PROCEDURE FOR NUT COVERS OR BASE COVER:

Note: The base covers for a 5in diameter pole and 6in diameter have a different size opening when the two halves are joined together. Base covers for a 5in dia pole will not fit on a 6in dia pole. Base covers for a 6in dia pole will have a large gap if installed incorrectly on a 5in dia pole.

For nut covers:

1. Install nut covers as shown in Fig. 15.

For base cover:

1. Place base covers in position. Loosen or tighten clamping screws as needed for proper fit. Using access holes on base covers, tighten socket head cap screws to secure two base cover halves together, see Figs. 16 and 17.

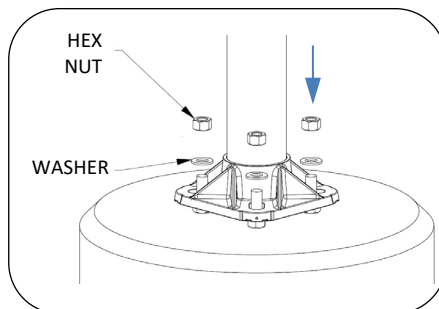

FIG. 14 – INSTALL POLE ON ANCHORS

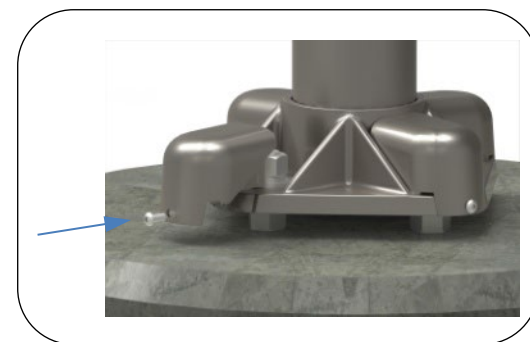

FIG. 15 – INSTALL NUT COVERS

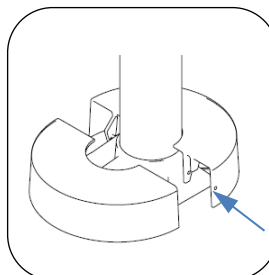

FIG. 16 – INSTALL OPTIONAL
BASE COVER

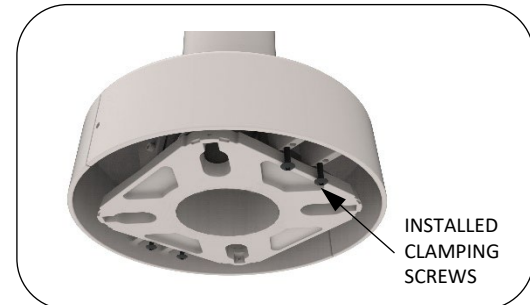

FIG. 17 – INSTALL OPTIONAL BASE COVER